



The Sound That Will *Move* You

IW-BTA250 KIT

Installation Guide



Earthquake Sound Corporation
2727 McCone Avenue. Hayward, CA 94545.USA
US Toll Free: 1-800-576-7944 | Tel: 510-732-1000 | Fax: 510-732-1095
www.earthquakesound.com

Introduction

The IW-BTA250 KIT is a wireless in-wall amplifier kit that packs flexibility, power and control all into one small discrete package. Each set comes with the IW-BTA250 amplifier, a B120R retrofit electrical box, a 24VDC power supply, and a cable adapter.

The IW-BTA250 two-channel stereo amplifier can accept signal through the front panel 3.5mm stereo mini jack and via Bluetooth® connection. It can produce 50 Watts RMS per channel at 4-Ohm. For added convenience, the IW-BTA250 also features a front mounted volume control knob.

Designed to fit in most standard single-gang junction box, the IW-BTA250 can be easily installed in any new or pre-existing constructions (homes, bars, restaurants, etc.)

Overview

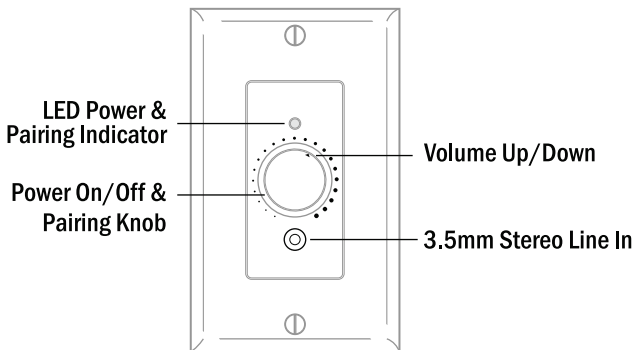

The volume knob of this IW-BTA250 amplifier also acts as the power and pairing button.

Press and hold the knob for 3 seconds to turn the amplifier on and off.

Simply press the volume knob to activate the pairing mode of the IW-BTA250 amplifier. This will disconnect any device connected to the amplifier and open the IW-BTA250 for pairing.

Connection Diagram

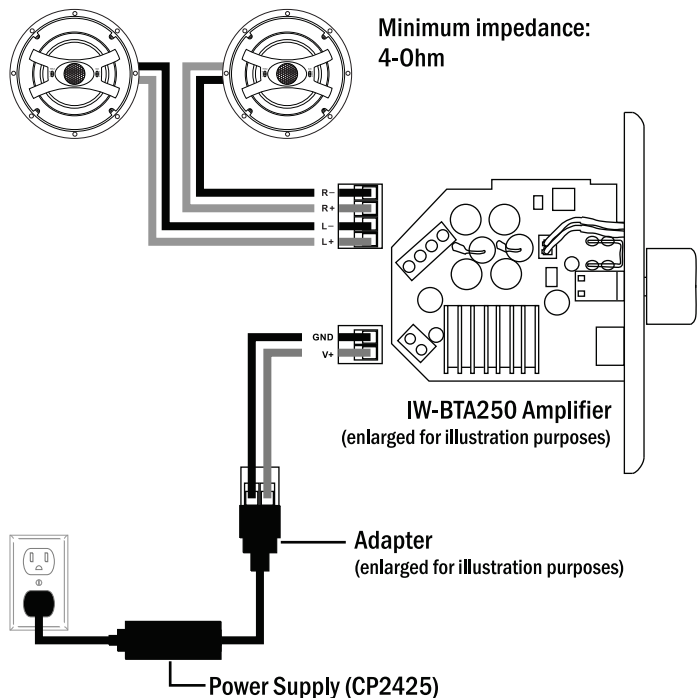

For optimum performance & power output use 24VDC/2A power supply

⚠ WARNING: Do NOT use below 4-Ohm stereo

Installation

! For your safety, the IW-BTA250 in-wall amplifier **MUST BE INSTALLED BY A LICENSED CONTRACTOR/ELECTRICIAN.**

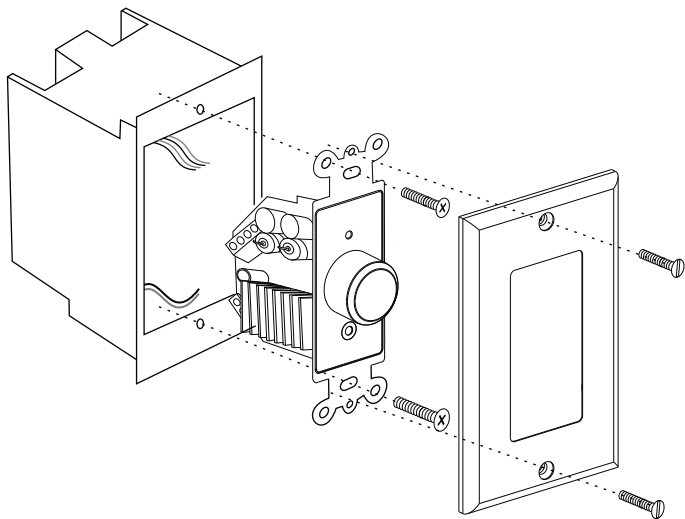

! For your safety, **THE PROVIDED ELECTRICAL BOX* MUST BE USED.**

* Suggested model no. B118/R, B120/R. Also available at your local hardware store

Specifications

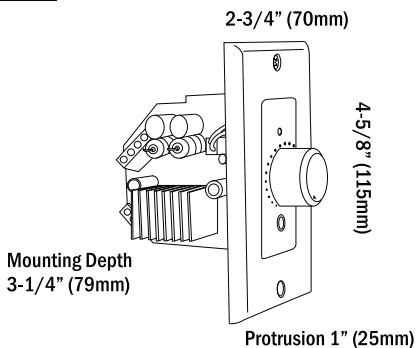

Output Power	2 x 50 WRMS @ 4-0hm 2 x 25 WRMS @ 2-0hm
Freq. Response	20Hz - 20kHz
THD	< 0.1% @ 1kHz
Signal-to-Noise	95 dB @ 4-0hm 1kHz
Input Impedance	20kOhm
Input Sensitivity	.01 - 1 V
Wireless Range	up to 32.8 feet (10m)
Power Supply	14 - 24 VDC / 2A - 5A

For technical support, please feel free to contact us via:

US Toll Free

1-800-576-7944

E-mail

tech@earthquakesound.com

Earthquake Sound warrants the original purchaser that all Factory Sealed New Audio products be free from defects in material and workmanship, under normal and proper use, for a period of one (1) year from the date of purchase (as shown on the original sales receipt with serial number affixed/written on it). The one (1) year warranty period is valid only if the product is properly installed by an Earthquake Sound authorized party and the warranty registration card is properly filled out and sent to Earthquake Sound Corporation. **If the product is installed by a non-authorized party, a thirty (30) day warranty period applies.**

(A) One (1) year limited warranty guidelines:

Earthquake pays for labor, parts and ground freight (**US Mainland only**) back to the customer.

(B) Warning:

Products (sent for repair) that are tested by Earthquake technicians and deemed to have no problem(s) will not be covered by the limited warranty. **Customer will be charged a minimum of one (1) hour of labor (at ongoing rate) plus the shipping charges back to the customer.**

(C) Earthquake agrees to repair or replace - at our discretion - all such defective products/parts subject to the following provisions:

- Defective products/parts have not been altered or repaired by other than an Earthquake factory approved technician.
- Products/parts are not subjected to negligence, misuse, improper use, or accident, damaged by improper line voltage, used with incompatible products, or have its serial number or any part of it altered, defaced or removed, or have been used in any way that is contrary to Earthquake's written instructions.

(D) Warranty Limitations:

Earthquake warranty does not cover products that have been modified or abused, including but not limited to the following:

- Damages due to misuse, abuse or use of improper cleaning materials/methods
- Bent frame, broken connectors, holes/cracked in wall plate, burnt parts
- Fading, deterioration of components & finish due to improper exposure to elements
- Burnt tracers on PCB
- Product/part damaged due to poor packaging or abusive shipping conditions
- Subsequent damage to other products

A warranty claim will not be valid if the warranty registration card is not properly filled & returned to Earthquake with a copy of the sales invoice.

(E) Service Request:

To receive product(s) service, contact Earthquake Sound's service department at (510) 732-1000 or tech@earthquakesound.com and request an RMA (Return Material Authorization) number as item(s) shipped without a valid RMA number will be refused. Make sure you provide us with your complete and correct shipping address, a valid daytime phone number, and a brief description of the problem you are experiencing with the product. In most cases, our technicians might be able to resolve the problem over the phone or via e-mail, thus eliminating the need to ship the product.

(F) Shipping Instructions:

Product(s) must be packaged inside its original protective box(es) to minimize transportation damage. Shipper claims regarding items damaged in transit must be presented to carrier. Earthquake Sound Corporation reserves the right to refuse improperly packaged product(s). A copy of the original sales receipt must accompany the product(s) returned for service. Ship the product(s) to:

Earthquake Sound Corporation. 2727 McCone Avenue. Hayward, CA 94545

The customer is responsible for the cost of shipping the product(s) to Earthquake Sound Corporation

(G) Disputes Resolution:

All disputes - between clients and Earthquake Sound Corporation - resulting from the one (1) year limited warranty policy must be resolved according to the laws & regulations of the county of Alameda, California.



The Sound That Will *Move* You

Earthquake Sound reserves the right to amend details of the specifications without notice

© Copyright Earthquake Sound Corporation

www.earthquakesound.com